

TH TYPE

(1) ORDERING CODE 產品名稱

Y9P TH 2.6 x 2.4 S14 OC3 P0.35
 Material Type Outside Diameter(AΦ) Length(D) Shape Thread Type Thread Pitch
 材質 形狀 外徑(AΦ) 長度(D) 形體 螺紋角度 螺紋節距

(2) SUITABLE MATERIAL (適用材質)

Y8P, Y9P.....

(3) SHAPE (圖形標示)

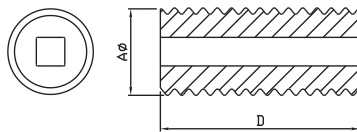

Fig 1

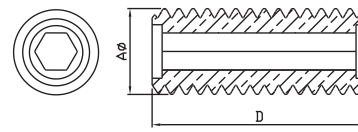

Fig 2

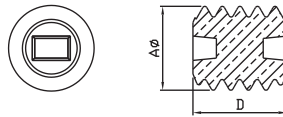

Fig 3



Fig 4

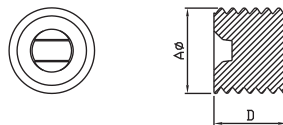
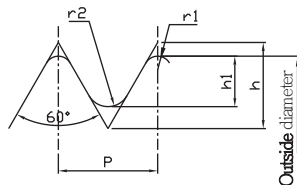
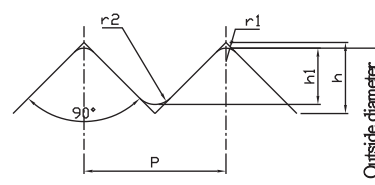

Fig 5



THREAD (OC-3)



THREAD (OC-4)

THREAD TYPE (螺紋角度)

Unit:mm

Thread	Pitch p	Depth engagement hl	Degree Θ	Crest radius r1	Root radius r2
OC-3	0.35±0.03	0.16 ^{+0.10} _{-0.05}	60±5	0.08+0	0.22
	0.50±0.03	0.23 ^{+0.10} _{-0.05}	60±5	0.08+0	0.22
	0.60±0.03	0.28 ^{+0.10} _{-0.05}	60±5	0.08+0	0.22
	0.75±0.03	0.35 ^{+0.14} _{-0.05}	60±5	0.08+0	0.22
	0.90±0.03	0.42 ^{+0.12} _{-0.05}	60±5	0.08+0	0.22
	1.00±0.03	0.47 ^{+0.12} _{-0.05}	60±5	0.08+0	0.22
OC-4	0.50±0.03	0.17 ^{+0.06} _{-0.05}	90 ⁺² ₋₈	0.05+0	0.15
	0.60±0.03	0.20 ^{+0.08} _{-0.05}	90 ⁺² ₋₈	0.05+0	0.15
	0.80±0.03	0.28 ^{+0.10} _{-0.03}	90 ⁺² ₋₈	0.05+0	0.15

(4)DIMENSIONS(尺寸)

Unit:mm

NO.	CORE	Fig	A ψ	D
1	TH 2x2 S14	5	2.00±0.03	2.00±0.15
2	TH 2.16x3 S14	4	2.16±0.03	3.00±0.20
3	TH 2.17x1.7 S14	5	2.17±0.03	1.70±0.15
4	TH 2.2x2.5 STD	3	2.20±0.03	2.50±0.20
5	TH 2.2x2.5 S14	4	2.20±0.03	2.50±0.20
6	TH 2.35x1.5 S14	5	2.35±0.03	1.50±0.15
7	TH 2.55x2.5 STD	3	2.55±0.03	2.50±0.20
8	TH 2.6x2.8 S14	4	2.60±0.03	2.80±0.20
9	TH 2.6x2 S14	3	2.60±0.03	2.00±0.20
10	TH 2.65x4 STD	3	2.65±0.03	4.00±0.20
11	TH 3.2x2 S14	5	3.20±0.03	2.00±0.20
12	TH 3.2x5 S14	4	3.20±0.03	5.00±0.20
13	TH 3.2x5 S8	1	3.20±0.03	5.00±0.20
14	TH 3.2x5 STD	3	3.20±0.03	5.00±0.20
15	TH 3.15x15 STD	3	3.15±0.03	15.0±0.30
16	TH 3.25x3 S14	4	3.25±0.03	3.00±0.20
17	TH 3.25x3 STD	3	3.25±0.03	3.00±0.20
18	TH 3.66x8 STD	3	3.66±0.03	8.00±0.20
19	TH 3.66x8 S14	4	3.66±0.03	8.00±0.20
20	TH 3.8x12 S14	4	3.80±0.03	12.0±0.30
21	TH 3.9x5 S14	4	3.90±0.03	5.00±0.20
22	TH 3.9x5 STD	3	3.90±0.03	5.00±0.20
23	TH 3.95x8 S8	1	3.95±0.03	8.00±0.20
24	TH 4x12 STD	3	4.00±0.03	12.0±0.20
25	TH 4.32x5 S14	4	4.32±0.03	5.00±0.20
26	TH 4.5x15 S8	1	4.50±0.03	15.0±0.30
27	TH 4.6x8 S4	2	4.60±0.03	8.00±0.20
28	TH 4.6x8 S14	4	4.60±0.03	8.00±0.20
29	TH 6x9 STD	3	6.00±0.03	9.00±0.20
30	TH 6x15 S4	2	6.00±0.03	15.0±0.30
31	TH 6x25 S4	2	6.00±0.03	25.0±0.40
32	TH 6.2x9 STD	3	6.20±0.03	9.00±0.20
33	TH 8x20 S4	2	8.00±0.03	20.0±0.40