

## RI TYPE

### (1) ORDERING CODE 產品名稱

C5	RI	4.5	x	3.6	x	2
Material	Type	Outside Diameter(AΦ)		Inside Diameter(CΦ)		Thickness(D)
材質	形狀	外徑(AΦ)		內徑(CΦ)		高度(D)

\*\*Combined with SRUM(配套DR CORE)  
C5 DR 3.5 x 1.9 B1.1 F1.1

### (2) SUITABLE MATERIAL (適用材質)

C6, C6, F4D, F5D, F6D, F7D .....

### (3) APPLICATION (產品適用)

FOR COMMUNICATION DEVICES, NOTEBOOK COMPUTER,  
PDA OA MACHINE, DIGITAL CAMERA.....  
通信器材, 手提電腦, 數位相機, 個人數位助理器.....

### (4) SHAPE (圖形標示)

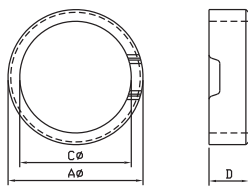

Fig 1

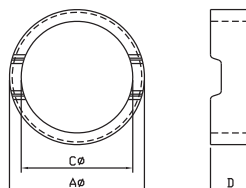

Fig 2

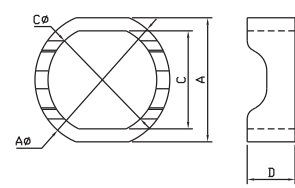

Fig 3

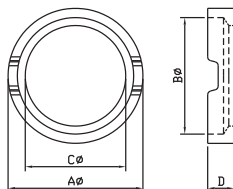

Fig 4

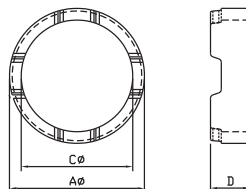

Fig 5

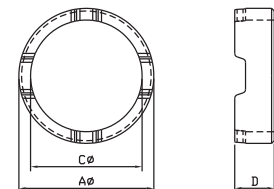

Fig 6

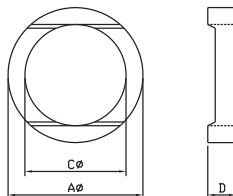

Fig 7

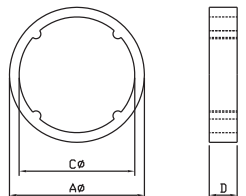

Fig 8

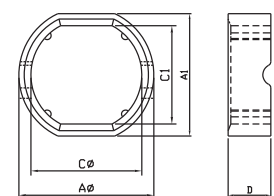

Fig 9

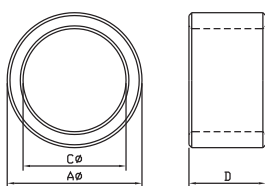

Fig 10

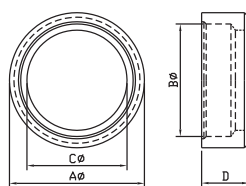

Fig 11

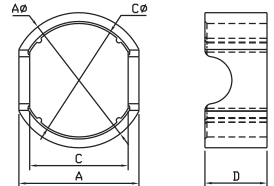
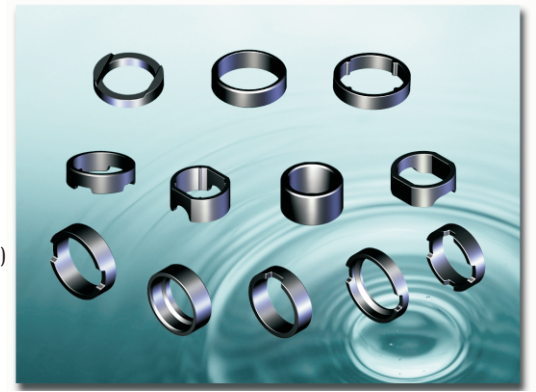

Fig 12



(5)DIMENSIONS(尺寸)

Unit:mm

NO.	CORE	Fig	A $\psi$	B $\psi$	C $\psi$	D	COMBINED WITH
1	RI 2.84x2.34x2.54	10	2.84 $\pm$ 0.10		2.34 $\pm$ 0.10	2.54 $\pm$ 0.10	DR 2.23x2.55(S)
2	RI 3x2.4x1.0	2	3.00 $\pm$ 0.15		2.40 $\pm$ 0.10	1.00 $\pm$ 0.10	DR 3x1.3 D3
3	RI 3.1x2.5x1.1	2	3.10 $\pm$ 0.15		2.50 $\pm$ 0.10	1.10 $\pm$ 0.10	DR 2.2x1.1
4	RI 3.25x2.58x2	1	3.25 $\pm$ 0.15		2.58 $\pm$ 0.10	2.00 $\pm$ 0.15	DR 2.5x1.9
5	RI 3.3x2.68x2.6	1	3.30 $\pm$ 0.15		2.68 $\pm$ 0.10	2.60 $\pm$ 0.15	DR 2.5x2.6
6	RI 3.4x2.6x2	2	3.40 $\pm$ 0.15		2.60 $\pm$ 0.10	2.00 $\pm$ 0.15	DR 2.5x2.1 DM
7	RI 3.4x2.6x2.2	5	3.40 $\pm$ 0.15		2.60 $\pm$ 0.10	2.20 $\pm$ 0.15	DR 2.5x2.2 DM
8	RI 3.4x2.8x2.4	5	3.40 $\pm$ 0.15		2.80 $\pm$ 0.10	2.40 $\pm$ 0.15	DR 2.7x2.1 DM
9	RI 3.5x2.7x1.3	2	3.50 $\pm$ 0.15		2.70 $\pm$ 0.10	1.30 $\pm$ 0.15	DR 3.5x1.6 D3
10	RI 3.5x2.8x0.9	2	3.50 $\pm$ 0.15		2.80 $\pm$ 0.10	0.90 $\pm$ 0.10	DRT 3.5x1.3(S) D3
11	RI 3.9x3.1x1.65	2	3.90 $\pm$ 0.15		3.10 $\pm$ 0.10	1.65 $\pm$ 0.15	DR 3.9x2.1(S) D3
12	RI 4x3x1.6	2	4.00 $\pm$ 0.15		3.00 $\pm$ 0.10	1.60 $\pm$ 0.15	DR 4x2.2 D3
13	RI 4x3.4x2	2	4.00 $\pm$ 0.15		3.40 $\pm$ 0.10	2.00 $\pm$ 0.15	DR 3.25x2
14	RI 4.1x3.11x1.5	2	4.10 $\pm$ 0.15		3.11 $\pm$ 0.10	1.50 $\pm$ 0.15	DR 4.2x1.95(S) D3
15	RI 4.5x3.6x1.5	2	4.50 $\pm$ 0.15		3.60 $\pm$ 0.10	1.50 $\pm$ 0.15	DR 3.5x1.4
16	RI 4.5x3.6x2	1	4.50 $\pm$ 0.15		3.60 $\pm$ 0.10	2.00 $\pm$ 0.15	DR 3.5x1.9
17	RI 5.1x3.8x1	2	5.10 $\pm$ 0.20		3.80 $\pm$ 0.15	1.00 $\pm$ 0.10	DR 3.7x1.25 DM
18	RI 5.1x4.4x1.0	4	5.10 $\pm$ 0.20	4.40 $\pm$ 0.15	3.80 $\pm$ 0.15	1.00 $\pm$ 0.10	DR 3.7x1.25 DM
19	RI 5.4x4.45x1.5	2	5.40 $\pm$ 0.20		4.45 $\pm$ 0.15	1.50 $\pm$ 0.15	DR 4.3x1.5
20	RI 5.8x4.8x1.6	2	5.80 $\pm$ 0.20		4.80 $\pm$ 0.15	1.60 $\pm$ 0.15	DR 4.45x2.2
21	RI 5.8x4.8x3.1	2	5.80 $\pm$ 0.20		4.80 $\pm$ 0.15	3.10 $\pm$ 0.15	DR 4.3x3.3
22	RI 5.8x4.8x4.1	2	5.80 $\pm$ 0.20		4.80 $\pm$ 0.15	4.10 $\pm$ 0.15	DR 4.3x4.3
23	RI 5.8x5x3.4	3	5.80 $\pm$ 0.20		5.00 $\pm$ 0.15	3.40 $\pm$ 0.15	DRT 5.8x4.5(S) D3
24	RI 5.95x5x2	2	5.95 $\pm$ 0.20		5.00 $\pm$ 0.15	2.00 $\pm$ 0.15	DR 4.55x2.2
25	RI 6x4.65x4.5	11	6.00 $\pm$ 0.20	5.00 $\pm$ 0.15	4.65 $\pm$ 0.15	4.50 $\pm$ 0.15	DR 4.4x4.2 DM
26	RI 6x4.45x2.1	11	6.00 $\pm$ 0.20	5.00 $\pm$ 0.15	4.45 $\pm$ 0.15	2.10 $\pm$ 0.15	DR 4.25x2.35
27	RI 6x4.7x3.6	2	6.00 $\pm$ 0.20		4.70 $\pm$ 0.15	3.60 $\pm$ 0.15	DR2W 6x6.3(S) RCH D3
28	RI 6.2x4.7x3.6	2	6.20 $\pm$ 0.20		4.70 $\pm$ 0.15	3.60 $\pm$ 0.15	DR2W 6.2x6.3(S)RCH D3
29	RI 6.2x5.0x2.2	3	6.20 $\pm$ 0.20		5.00 $\pm$ 0.15	2.20 $\pm$ 0.15	DRT 6.2x3.2 D3
30	RI 6.6x4.7x1.5	4	6.60 $\pm$ 0.20		4.70 $\pm$ 0.15	1.50 $\pm$ 0.15	DR 4.5x1.8
31	RI 6.8x5.8x2.3	2	6.80 $\pm$ 0.20		5.80 $\pm$ 0.20	2.30 $\pm$ 0.15	DR 5.4x2.6

## DIMENSIONS(尺寸)

Unit:mm

NO.	CORE	Fig	A $\psi$	B $\psi$	C $\psi$	D	COMBINED WITH
32	RI 6.8x5.8x3.4	2	6.80±0.20		5.80±0.20	3.40±0.15	DR 5.3x4
33	RI 6.9x5.9x3.7	2	6.90±0.20		5.90±0.20	3.70±0.15	DR 5.4x4(S)
34	RI 7x5x1.8	7	7.00±0.20		5.00±0.20	1.80±0.15	DR 4.9x1.7
35	RI 7x5x3.4	7	7.00±0.20		5.00±0.15	3.40±0.15	DR 4.8x3.85 DM
36	RI 7x6x1.1	2	7.00±0.20		6.00±0.15	1.10±0.10	DR 5.4x1.4
37	RI 7x6x3.5	11	7.00±0.20	6.00±0.15	5.20±0.15	3.50±0.15	DR 5x3.5
38	RI 7.2x5.4x1.5	7	7.20±0.20		5.40±0.15	1.50±0.15	DR 4.9x1.9
39	RI 7.3x6.1x1.9	10	7.30±0.20		6.10±0.15	1.90±0.15	DR 5.4x2.5
40	RI 7.4x6x1.45	8	7.40±0.20		6.00±0.15	1.45±0.15	DR 5.4x2
41	RI 7.4x6.1x2.85	5	7.40±0.20		6.10±0.15	2.85±0.15	DRT 7.4x4.6(S) D3
42	RI 7.5x5.7x3.5	11	7.50±0.20		5.70±0.15	3.50±0.15	DR5.45x4.25 DM
43	RI 7.5x6.35x1.95	5	7.50±0.20		6.35±0.15	1.95±0.15	DRT 7.5x3.7(S) D3
44	RI 7.8x6.2x3	3	7.80±0.20		6.20±0.15	3.00±0.15	DRT 7.8x4.5 D3
45	RI 7.8x6.4x4.6	12	7.80±0.20		6.40±0.15	4.60±0.15	DR 5.8x4.6
46	RI 7.8x6.5x3	3	7.80±0.20		6.50±0.15	3.00±0.15	DRT 7.8x4.5 D3
47	RI 7.8x6.5x4.2	2	7.80±0.20		6.50±0.15	4.20±0.15	DR2W 7.8x7(S) RCH D3
48	RI 7.85x6.65x5.3	4	7.85±0.20		6.65±0.15	5.30±0.15	DR 5.5x5.8
49	RI 7.9x6.2x2.7	5	7.90±0.20		6.20±0.15	2.70±0.15	DR 5.4x3.2(S)
50	RI 8.4x6.8x4.1	2	8.40±0.20		6.80±0.15	4.10±0.15	DR 4.8x4
51	RI 9x7x3.35	2	9.00±0.20		7.00±0.15	3.35±0.15	DR 6.45x3.45
52	RI 9.5x8x2.2	5	9.50±0.20		8.00±0.15	2.20±0.15	DRT 9.5x3.7(S) D3
53	RI 9.85x7.4x3.7	2	9.85±0.20		7.40±0.15	3.70±0.20	DR 7.2x4.3(S)
54	RI 9.85x8x1.6	5	9.85±0.20		8.00±0.15	1.60±0.15	DR 7.2x2.3(S)
55	RI 9.85x8x1.6	6	9.85±0.20		8.00±0.15	1.60±0.15	DR 7.2x2.3(S)
56	RI 9.85x8x3.7	5	9.85±0.20		8.00±0.15	3.70±0.15	DR 7.2x4.3(S)
57	RI 9.8x8x3.8	2	9.80±0.20		8.00±0.15	3.80±0.15	DR 7.4x4
58	RI 9.9x8.1x3.4	4	9.90±0.20	8.40±0.15	8.10±0.15	3.40±0.15	DR 7.7x3.7
59	RI 9.9x8.15x2.6	5	9.90±0.20		8.15±0.15	2.60±0.15	DRT 9.8x4.3(S) D3
60	RI 9.9x8.15x5.1	2	9.90±0.20		8.15±0.15	5.10±0.15	DR 7.6x5.6
61	RI 9.9x8.2x3.2	3	9.90±0.20		8.20±0.15	3.20±0.15	DRT 10x5(S) D3
62	RI 9.9x8.4x3.2	2	9.90±0.20		8.40±0.15	3.20±0.15	DR 7.7x3.65

DIMENSIONS(尺寸)

Unit:mm

NO.	CORE	Fig	A $\psi$	B $\psi$	C $\psi$	D	COMBINED WITH
63	RI 10x8x3.5	4	10.0 $\pm$ 0.20		8.00 $\pm$ 0.15	3.50 $\pm$ 0.15	DR 7.6x3.6
64	RI 10x8.2x6.4	2	10.0 $\pm$ 0.20		8.20 $\pm$ 0.15	6.40 $\pm$ 0.15	DR4W 10x10(S) D3 RCH
65	RI 10x8.4x1.8	2	10.0 $\pm$ 0.20		8.40 $\pm$ 0.15	1.80 $\pm$ 0.15	DR 7.85x2.2
66	RI 10x8.4x4.6	12	10.0 $\pm$ 0.20		8.40 $\pm$ 0.15	4.60 $\pm$ 0.15	DR 7.8x4.6
67	RI 10.25x8.55x11.4	10	10.25 $\pm$ 0.20		8.55 $\pm$ 0.15	11.4 $\pm$ 0.20	DR4W 7.65x11(4S)
68	RI 10.5x8.6x6	3	10.5 $\pm$ 0.20		8.60 $\pm$ 0.15	6.00 $\pm$ 0.15	DR2W 7.8x4(S) D41M
69	RI 11x8.3x12	2	11.0 $\pm$ 0.20		8.30 $\pm$ 0.15	12.0 $\pm$ 0.30	DR2W 7.8x10(S)
70	RI 11.1x9.4x11.4	10	11.1 $\pm$ 0.20		9.40 $\pm$ 0.15	11.4 $\pm$ 0.30	DR4W 9x11.1
71	RI 12x10.3x6.1	2	12.0 $\pm$ 0.20		10.3 $\pm$ 0.15	6.10 $\pm$ 0.30	DR2W 12x10(S)RCH D3
72	RI 12.2x10.1x4.1	4	12.2 $\pm$ 0.20	10.4 $\pm$ 0.15	10.1 $\pm$ 0.15	4.10 $\pm$ 0.15	DR 9.6x4.3
73	RI 12.2x10.6x6.8	5	12.2 $\pm$ 0.25		10.6 $\pm$ 0.25	6.80 $\pm$ 0.20	DR 9.8x7 SO
74	RI 12.2x10.4x4.2	2	12.2 $\pm$ 0.20		10.4 $\pm$ 0.15	4.20 $\pm$ 0.15	DR 9.4x4.2(S)
75	RI 12.35x10.1x4.4	4	12.35 $\pm$ 0.20	10.5 $\pm$ 0.15	10.1 $\pm$ 0.15	4.40 $\pm$ 0.15	DR 9.5x4.7 (S)
76	RI 12.35x9.9x4.4	4	12.35 $\pm$ 0.20	10.5 $\pm$ 0.15	9.90 $\pm$ 0.15	4.40 $\pm$ 0.15	DR 9.5x4.7 (S)
77	RI 12.4x9.8x6.1	2	12.4 $\pm$ 0.20		9.80 $\pm$ 0.15	6.10 $\pm$ 0.15	DR 9x6
78	RI 12.4x9.8x5.5	10	12.4 $\pm$ 0.20		9.80 $\pm$ 0.15	5.50 $\pm$ 0.15	DR 9x5.9 DM
79	RI 12.4x10.6x2.7	10	12.4 $\pm$ 0.20		10.6 $\pm$ 0.15	2.70 $\pm$ 0.15	DR 10x3
80	RI 12.5x9.3x4.2	11	12.5 $\pm$ 0.25	10.4 $\pm$ 0.15	9.30 $\pm$ 0.15	4.20 $\pm$ 0.20	DR 9x4.1 中心凹點
81	RI 12.5x9.3x4.2	11	12.5 $\pm$ 0.20	9.80 $\pm$ 0.15	9.30 $\pm$ 0.15	4.20 $\pm$ 0.15	DR 9x4.1 中心凹點
82	RI 12.5x10.65x3	3	12.5 $\pm$ 0.20		10.65 $\pm$ 0.15	3.00 $\pm$ 0.15	DRT 12.5x5.4(S)D3
83	RI 12.6x10.8x5.3	3	12.6 $\pm$ 0.20		10.8 $\pm$ 0.25	5.30 $\pm$ 0.15	DRT 10x5.4
84	RI 12.6x10.9x5.75	2	12.6 $\pm$ 0.20		10.9 $\pm$ 0.20	5.75 $\pm$ 0.15	DR 9.7x5.7(S)
85	RI 12.7x11x4.0	5	12.7 $\pm$ 0.20		11.0 $\pm$ 0.25	4.00 $\pm$ 0.15	DRT 13x6.8 (S)D3
86	RI 12.7x11x5.5	2	12.7 $\pm$ 0.20		11.0 $\pm$ 0.25	5.50 $\pm$ 0.15	DR 9.8x5.7(S)
87	RI 12.8x11.1x5.8	2	12.8 $\pm$ 0.20		11.1 $\pm$ 0.25	5.80 $\pm$ 0.15	DR 9.8x5.8
88	RI 14.4x11x4.4	10	14.4 $\pm$ 0.25		11.0 $\pm$ 0.25	4.40 $\pm$ 0.20	DR 10x4
89	RI 14.2x12.2x5.6	5	14.2 $\pm$ 0.25		12.2 $\pm$ 0.25	5.60 $\pm$ 0.20	DR 11x6.2(S)
90	RI 14.5x11x7	11	14.5 $\pm$ 0.20	11.0 $\pm$ 0.25	10.5 $\pm$ 0.15	7.00 $\pm$ 0.15	DR 10x6.5
91	RI 15.5x11.3x9	11	15.5 $\pm$ 0.25	12.7 $\pm$ 0.25	11.3 $\pm$ 0.25	9.00 $\pm$ 0.20	DR 11x8.9
92	RI 15.6x13.4x14	10	15.6 $\pm$ 0.20		13.4 $\pm$ 0.25	14.0 $\pm$ 0.20	DR2W 12x13(S)
93	RI 16x14x13.5	2	16.0 $\pm$ 0.30		14.0 $\pm$ 0.30	13.5 $\pm$ 0.30	D2 16x16(S)D3