

FP,PL TYPE

(1) ORDERING CODE 產品名稱

C5A	FP	19	x	6.5	x	12
Material	Type	Length(A)		Width(B)		Thickness(D)
材質	形狀	長度(A)		寬度(B)		高度(D)

C5A	PL	38.1	x	25.4	x	6.35
Material	Type	Length(A)		Width(B)		Thickness(D)
材質	形狀	長度(A)		寬度(B)		高度(D)

(2) SUITABLE MATERIAL(適用材質)

C5A,C5,C6

(3) SHAPE(圖形標示)

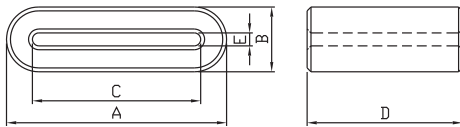
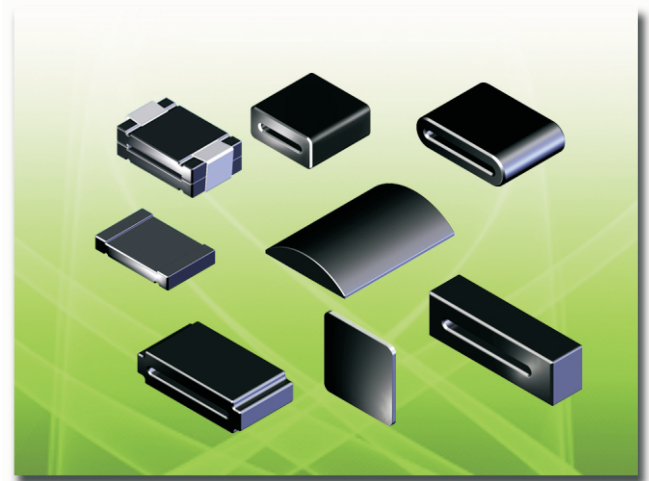

Fig 1

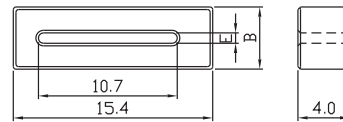

Fig 2

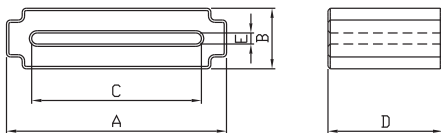

Fig 3

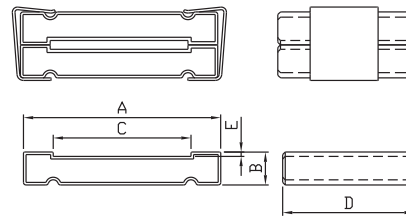

Fig 4

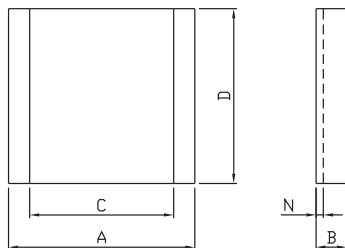

Fig 5

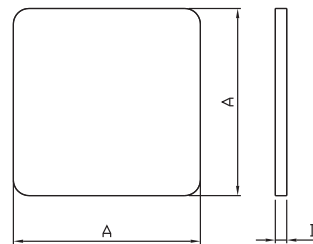

Fig 6

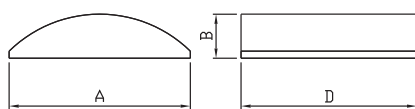

Fig 7

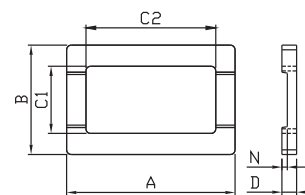

Fig 8

(4)DIMENSIONS(尺寸)

Unit:mm

NO.	CORE	Fig	A	B	C	D	E
1	FP 13.7x5.3x18	2	13.7±0.40	5.30±0.30	9.20±0.30	18.0±0.40	0.80±0.20
2	FP 13.7x7.7x12.3	1	13.7±0.40	7.70±0.40	10.0±0.30	12.3±0.40	4.25±0.30
3	FP 15x6.5x12	1	15.0±0.40	6.50±0.30	10.0±0.30	12.0±0.40	1.50±0.30
4	FP 16x5x12	1	16.0±0.40	5 ⁺⁰ _{-0.70}	11.5±0.50	12.0±0.50	0.80±0.30
5	FP 16x5x12	1	16.0±0.40	5.00±0.20	11.5±0.50	12.0±0.50	1.20±0.20
6	FP 17x5x12	1	17.0±0.40	5.00±0.30	11.5±0.50	12.0±0.40	0.80±0.20
7	FP 17x5x12	1	17.0±0.40	5.00±0.30	11.5±0.50	12.0±0.40	1.00±0.20
8	FP 18x5x8	1	18.0±0.40	5.00±0.30	14.0±0.40	8.00±0.30	1.00±0.20
9	FP 19x6.5x12	1	19.0±0.50	6.50±0.30	13.8±0.50	12.0±0.40	1.50±0.30
10	FP 19.3x7.6x28.6	1	19.3±0.50	7.60±0.40	13.0±0.40	28.6±0.60	1.30±0.30
11	FP 22.35x7.75x19	2	23.35±0.50	7.75±0.30	14.0±0.40	19.0±0.40	1.50±0.20
12	FP 23.8x6.3x15	1	23.8±0.80	6.30±0.30	19.5±0.50	15.0±0.40	1.10±0.20
13	FP 26x6.5x12	1	26.0±0.80	6.50±0.30	21.0±0.50	12.0±0.40	1.50±0.30
14	FP 27x14.5x12.5	1	27.0±0.80	14.5±0.50	18.8±0.50	12.5±0.40	6.70±0.30
15	FP 27x5.5x12	1	27.0±0.80	5.50±0.30	22.0±0.50	12.0±0.40	1.50±0.30
16	FP 28x7.7x14.6	3	28.0±1.00	7.70±0.30	23.0±0.50	14.6±0.40	1.40±0.30
17	FP 28.6x7.7x9.7	1	28.6±1.00	7.70±0.30	23.4±0.50	9.70±0.30	1.70±0.30
18	FP 28.5x6.5x18	1	28.5±1.00	6.50±0.50	23.5±0.50	18.0±0.40	1.10±0.20
19	FP 32x7.75x35	1	32.0±1.00	7.75±0.30	25.0±0.50	35.0±1.00	0.90±0.20
20	FP 33.5x6.5x12	1	33.5±1.00	6.50±0.30	28.0±0.50	12.0±0.40	1.10±0.20
21	FP 33.5x6.5x12	1	33.5±1.00	6.50±0.30	27.3±0.50	12.0±0.40	1.40±0.20
22	FP 38.5x12x25.4	2	38.5±1.00	12.0±0.40	26.8±0.50	25.4±0.80	1.80±0.30
23	FP 39x12.5x12.5	1	39.0±1.00	12.5±0.40	31.5±0.50	12.5±0.40	4.50±0.30
24	FP 40x6.5x12	1	40.0±1.00	6.50±0.30	35.0±1.00	12.0±0.40	1.30±0.30
25	FP 40x6.5x23.5	1	40.0±1.00	6.50±0.30	35.0±1.00	23.5±0.80	1.30±0.30
26	FP 45.2x6.5x12	1	45.2±1.00	6.50±0.30	40.0±1.00	12.0±0.40	1.50±0.30
27	FP 49.6x6.5x20	1	49.6±1.00	6.50±0.30	45.0±1.00	20.0±0.40	1.50±0.30
28	FP 57.6x6.5x12	1	57.6±1.00	6.50±0.30	52.0±1.00	12.0±0.40	1.50±0.30
29	FP 63.5x12.7x28.5	2	63.5±1.00	12.7±0.40	52.5±1.00	28.5±0.80	1.60±0.30
30	FP 64x13x15	2	64.0±1.20	13.0±0.40	52.5±1.00	15.0±0.40	1.60±0.30
31	FP 64x13x28	2	64.0±1.20	13.0±0.40	52.5±1.00	28.0±0.80	1.60±0.30
32	FP 31x5x12	1	31.0±0.80	5 ⁺⁰ _{-0.40}	27.4±0.50	12.0±0.40	0.90±0.30

DIMENSIONS(尺寸)

Unit:mm

NO.	CORE	Fig	A	B	C	D	E
1	PL 12.8x2.1x12	5	12.8±0.40	2.10±0.15	9.90±0.20	12.0±0.30	0.50±0.10
2	PL 14x3.4x19.4	7	14.0±0.40	3.40±0.30		19.4±0.60	
3	PL 27x27x2	6	27.0±1.00	27.0±1.00		2.00±0.40	
4	PL 36x36x2.2	6	36.0 ⁰	36.0 ⁰		2.20±0.40	
5	PL 38x38x2	6	38.0±1.00	38.0±1.00		2.00±0.40	
6	PL 38.1x25.4x6.35	4	38.1±1.00	6.35±0.25	26.6±0.70	25.4±0.70	1.70±0.20
7	PL 45.1x28.5x6.35	4	45.1±1.50	6.35±0.50	34.4±1.00	28.5±0.50	0.85±0.20
8	PL 63.5x28.5x6.35	4	63.5±1.30	6.35±0.25	52.1±1.00	28.5±0.80	0.80±0.30
9	PL 76.2x28.5x0.7	4	76.2±1.50	6.70±0.30	65.3±1.30	28.5±0.80	1.10±0.30
10	PL 36.65x23.65x3.15	8	36.65±1.00	23.65±1.00	14.6±0.50	3.15±0.15	